

StratCat 27 HYBRID CTV



Strategic Marine
Built to work.



PRINCIPAL PARTICULARS

Length Overall:	27.0m
Load Line Length:	23.9m
Length Waterline:	25.6m
Beam Moulded:	8.90m
Beam (Demihull CL):	5.95m
Design Draft:	1.50m
Scantling Draft:	1.71m
Construction:	Marine Grade Aluminium
Structural Warranty:	24 Months (2 Years)

REGULATORY

Class:	BV/IACS
Flag:	TBA
Notation:	I ✘ HULL • MACH Wind Farm
GRT:	Service Ship – SO Sea Area 3
Designer:	>200 (Option for < 200GT)
CAPACITIES	BMT

CAPACITIES

Fuel:	35,000 L
Fresh Water:	3,500 L
Black Water:	2,500 L
Crew:	3
Passengers:	24
Cabins:	4 x Two Berths + 1 x Single Berth
Max Deadweight:	35 Tonnes
Cargo Deck Area:	81.7m ²
Auxiliary:	2 x Kohler or Similar

FEATURED OPTIONS

Active Fender II:	Safe Transfer of Passengers
Deck Crane:	Palfinger or Similar
IMO Tier III:	SCR System
HYBRID Propulsion:	PTI/PTO with Battery
Ride Control:	Humphree or Similar
Biosafe Notation:	Infectious Disease Control
Green passport:	Safe Ship Recycling
DPO:	Dynamic Positioning
Bow Thruster:	0.45 Tonnes of Thrust

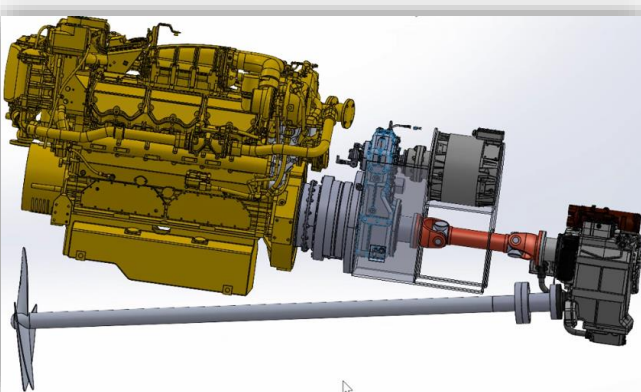

Crew Transfer Vessel

StratCat 27 HYBRID CTV



Strategic Marine
Built to work.



OUTBOARD PROFILE



VIEW ON BOW

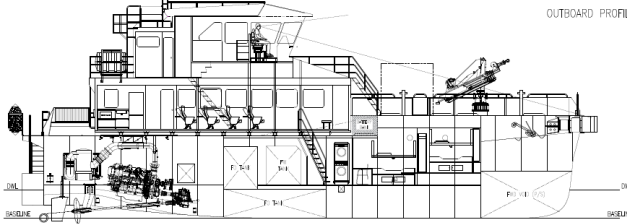

INBOARD PROFILE

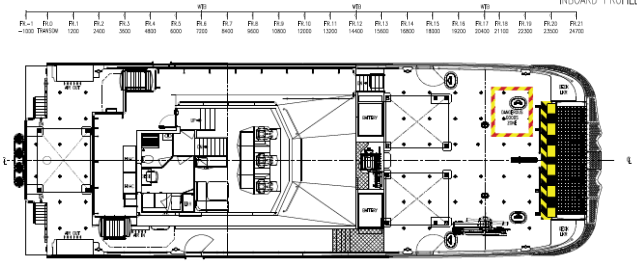

PLAN VIEW BRIDGE

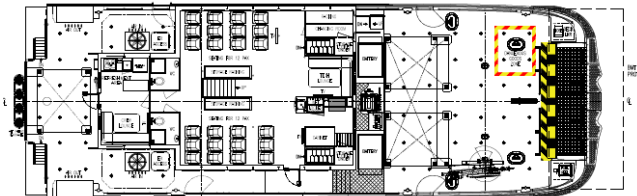

PLAN VIEW ON MAIN DECK



Crew Transfer Vessel

PROPULSION SYSTEM – HYBRID

Main Engines:	2 x CATERPILLAR C32 (2 x 1081kW/2300rpm)
Propulsion:	2 x Fixed Pitch Propellers
Speed @85%:	24.0 Knots (10DWT), 490 l/hr @ 85% MCR
Speed @100%:	26.0 Knots (10DWT), 581 l/hr @ 100% MCR
Bollard Push:	14.0 Tonnes (Approx.)
E-Motors:	2 x 110kW Danfoss E-Motors (European/German)
Transmission:	2 x ZF 3050 + 2 x Esco Parallel Hybrid Gearbox with Clutch
Battery System:	110 kWh (LFP) Energy Storage & Battery Management System
HYBRID Control System:	15" HMI Display in W/H, Interfaced with Main Propulsion System
HYBRID Cooling:	Fresh Water Cooled E-Motor and Battery System
Operation Modes:	Two simple and separate modes of operation <ol style="list-style-type: none"> 1. "Green" where the HYBRID propulsion system is automated, electric under approx. 9 knots and Diesel above approx. 9 knots 2. "Power" specific for technician transfer operations, where the Diesel engines are running 100% of the time

Strategic Marine Group | Office: +65 6932 9905
sales@strategicmarine.com | www.strategicmarine.com